

# TouchWo®

## 65" Touch Monitor

Model : HR65

### Views & Dimensions

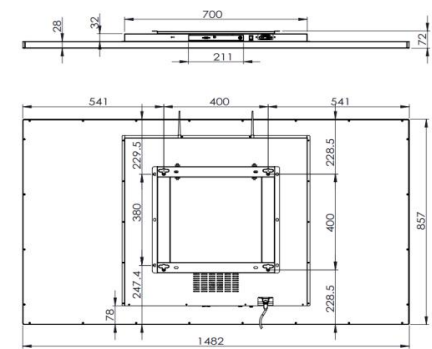
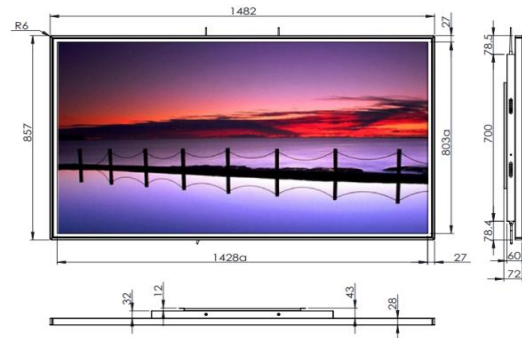

### Features

- **24/7 Commercial Use**

Industrial-grade Power Supply

30,000-hour extended life LCD display

- **Wall mounted / Floor stand etc**

- **Stylish Appearance**

Industry-leading ultra-narrow screen bezel

Full aluminum alloy frame

- **Surface IP65 waterproof**



## Tech Specs

LCD Panel		Touch Panel	
Screen diagonal	65 inch	Touch technology	Infrared
Physical resolution	1920*1080	Response time	<5ms
Aspect ratio	16:09	Touch points	10 points standard
Display active screen size	1428 * 803 mm	Touch effective recognition	>1.5mm
Colours displayed	16.7M	Scanning frequency	200Hz
Brightness (cd/m2)	300	Scanning accuracy	32768×32768
Contrast	3000:1	Working current/voltage	180Ma/DC+5V±5%
Visual angle H/V (°)	175/175	Surface hardness	Mohs class 7 explosion-proof glass
Backlight lifetime (hours)	LED 30,000		
Refrash rate	60 Hz		

Operation Environment		Dimension	
Operation Temperature	0°C-50°C	Machine(cm)	148.2 (L) *85.7 (W) * 6 (H)
Operation Humidity	10% - 80%	Package(cm)	154.5 (L) *92 (W) * 15 (H)
Storage Temperature	-5°C-60°C	Net weight	37.8 KG
Storage Humidity	10% - 85%	Gross weight	47.8 KG

**Power supply parameters**

<b>Power Input</b>	110-240V AC 50/60Hz	<b>Manual</b>	* 1	
<b>Power Output</b>	DC 12V5A	<b>Included in the Delivery</b>	<b>Wall mount bracket</b>	* 1
<b>Standby power consumption</b>	≤0.5W		<b>USB &amp; HDMI cable</b>	* 1
<b>Overall power consumption</b>	<110W		<b>Power cable</b>	* 1

## External Connectors

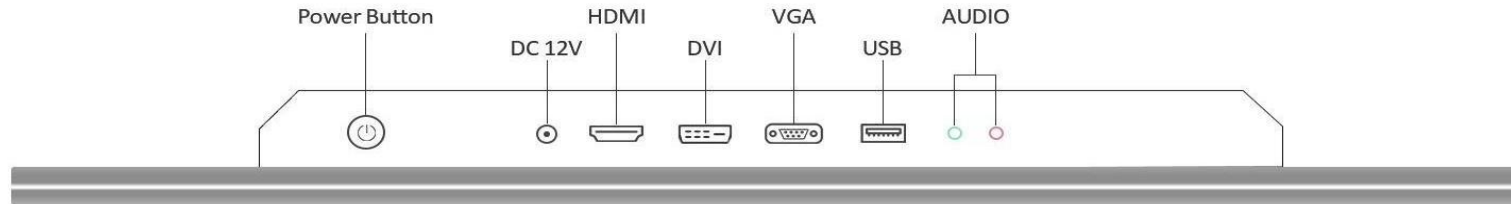

Power Socket	* 1	DC12V	* 1	HDMI in	* 1	Audio in&out	* 1
DVI	* 1	VGA	* 1	USB	*1		

## Use Case

